

Proposed Addition to JOHN F. KENNEDY ELEMENTARY SCHOOL

SPRING VALLEY C.C.S.D. No. 99
SPRING VALLEY, ILLINOIS

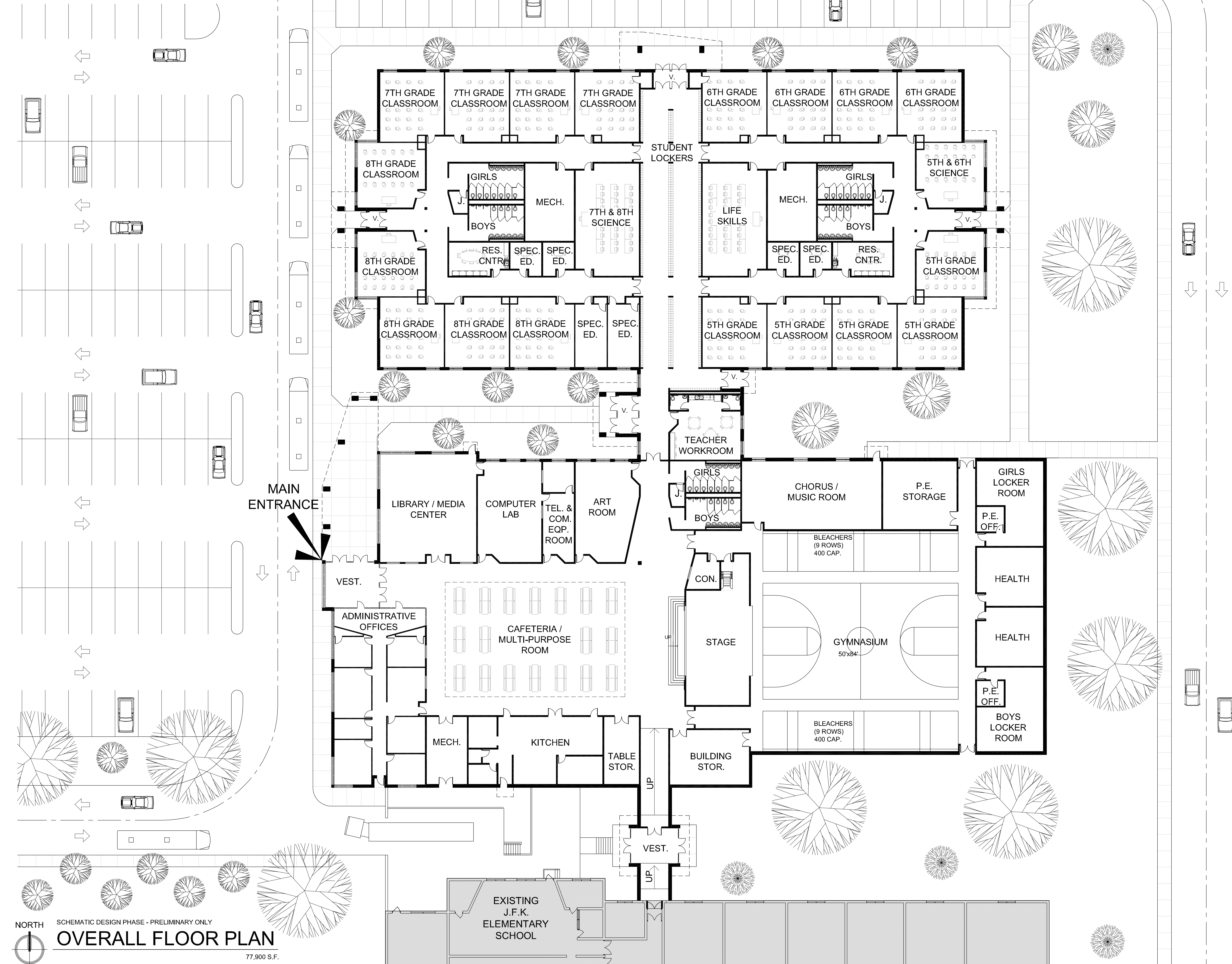

NORTH
SCHEMATIC DESIGN PHASE - PRELIMINARY ONLY
OVERALL FLOOR PLAN
77,900 S.F.

adc
Allied Design Consultants, Inc.
Architecture • Design • Planning
405 1/2 South Sixth Street
Springfield, Illinois 62701
217.522.3355 Fax 217.522.5570
alliedsn@fci.net
JUNE 20, 2012